

## Strut Fittings & Accessories

### Channel Nuts

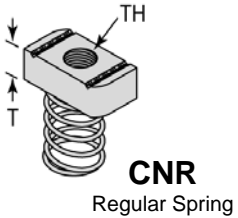

| Item #      | Description             | TH        | T       | Box Qty. |
|-------------|-------------------------|-----------|---------|----------|
| PH-CNR30037 | Spring Nut (use w/ B22) | 3/8" – 16 | .37 in. | 100      |
| PH-CNR40050 | Spring Nut (use w/ B22) | 1/2" – 13 | .50 in. | 100      |
| PH-CNS30037 | Spring Nut (use w/ B54) | 3/8" – 16 | .37 in. | 100      |

**CALL  
FOR  
PRICES**

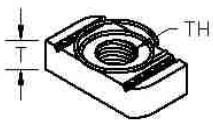

| Item #      | Description | TH        | T       | Box Qty. |
|-------------|-------------|-----------|---------|----------|
| PH-CNT30037 | Twirl Nut   | 3/8" – 16 | .37 in. | 100      |
| PH-CNT40050 | Twirl Nut   | 1/2" – 13 | .50 in. | 100      |

### Flat Strut Fittings

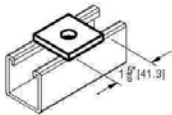

| Item #     | Description                    | Bolt Size | Hole Size | Box Qty. |
|------------|--------------------------------|-----------|-----------|----------|
| PH-F09-USA | Domestic Square Washer         | 5/16"     | 3/8"      | 100      |
| PH-F11-USA | Domestic Square Washer         | 3/8"      | 7/16"     | 100      |
| PH-F12-USA | Domestic Square Washer         | 1/2"      | 9/16"     | 100      |
| PH-F21-USA | Domestic Notched Square Washer | 3/8"      | 7/16"     | 100      |

Notched Square Washer

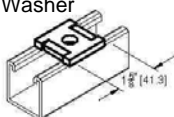

**DRIVEKORE**

101 Wesley Drive • Mechanicsburg, PA 17055 • Phone: (717) 766-7636 • Toll-Free (800) 382-1311  
 Fax: (717) 697-7477 • Toll-Free Fax: (800) 739-1101 • Email: orders@DriveKore.com

www.DriveKore.com

## Strut Fittings & Accessories

### Flat and Angle Strut Fittings

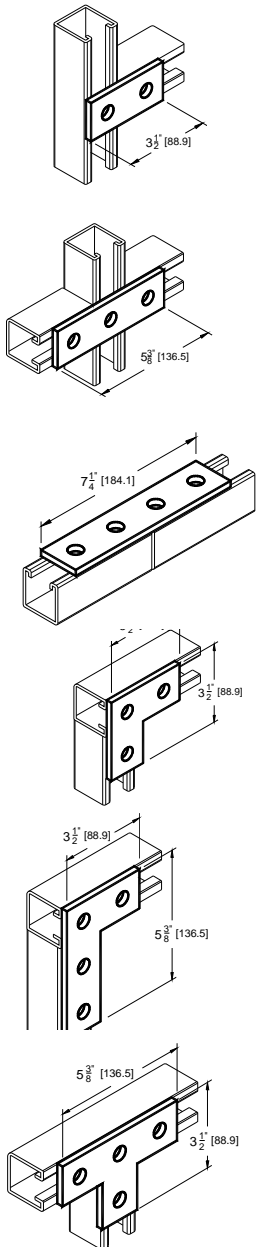

| Item #     | Description                  | Size | Box Qty. |
|------------|------------------------------|------|----------|
| PH-F30-USA | Domestic 2 Hole Splice Plate | B129 | 50       |
| PH-F31-USA | Domestic 3 Hole Splice Plate | B141 | 25       |
| PH-F32-USA | Domestic 4 Hole Splice Plate | B341 | 25       |
| PH-F50-USA | Domestic 3 Hole Corner Plate | B140 | 25       |
| PH-F51-USA | Domestic 4 Hole Corner Plate | B143 | 20       |
| PH-F60-USA | Domestic 4 Hole Tee Plate    | B133 | 20       |

**CALL  
FOR  
PRICES**

**DRIVEKORE**

101 Wesley Drive • Mechanicsburg, PA 17055 • Phone: (717) 766-7636 • Toll-Free (800) 382-1311  
 Fax: (717) 697-7477 • Toll-Free Fax: (800) 739-1101 • Email: [orders@DriveKore.com](mailto:orders@DriveKore.com)

[www.DriveKore.com](http://www.DriveKore.com)

# Strut Fittings & Accessories

## Angle Strut Fittings

**CALL  
 FOR  
 PRICES**

| Item #     | Description                        | Size   | Box Qty. |
|------------|------------------------------------|--------|----------|
| PH-L20-USA | Domestic 2 Hole Cross Corner Angle | B101   | 50       |
| PH-L21-USA | Domestic 3 Hole Corner Angle       | B103   | 25       |
| PH-L30-USA | Domestic 3 Hole 3 Way Corner Angle | B102   | 25       |
| PH-L31-USA | Domestic 4 Hole 3 Way Corner Angle | B104   | 25       |
| PH-P11-USA | Domestic 2 Hole Post Base for B22  | B280FL | 5        |
| PH-P13-USA | Domestic 4 Hole Post Base for B22  | B280   | 5        |
| PH-P14-USA | Domestic 4 Hole Post Base for B22  | B280SQ | 5        |

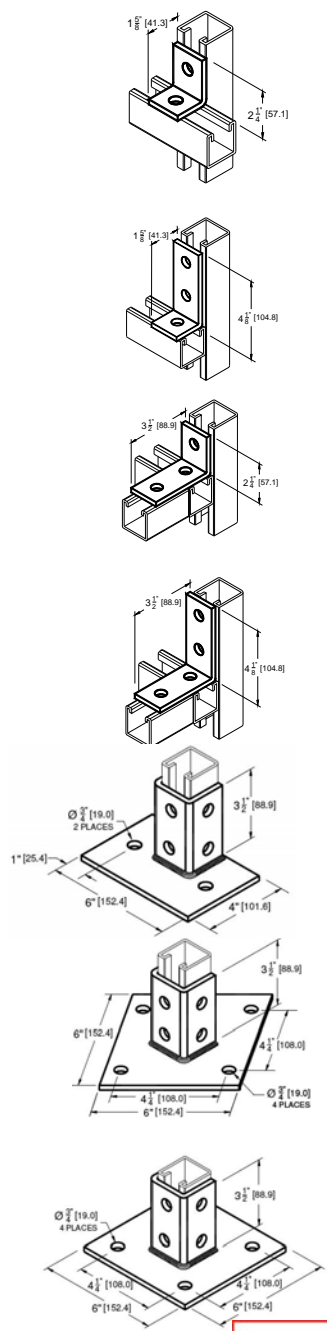

**DRIVEKORE**  
 101 Wesley Drive • Mechanicsburg, PA 17055 • Phone: (717) 766-7636 • Toll-Free (800) 382-1311  
 Fax: (717) 697-7477 • Toll-Free Fax: (800) 739-1101 • Email: orders@DriveKore.com

**Strut Fittings & Accessories**

**Pipe Clamps**



| Item #         | Description               | Tubing O.D. Size | Box Qty. |
|----------------|---------------------------|------------------|----------|
| PH-CCT0062-USA | Domestic O.D. Vibra Clamp | 5/8"             | 25       |
| PH-CCT0087-USA | Domestic O.D. Vibra Clamp | 7/8"             | 25       |
| PH-CCT0112-USA | Domestic O.D. Vibra Clamp | 1-1/8"           | 10       |
| PH-CCT0137-USA | Domestic O.D. Vibra Clamp | 1-3/8"           | 10       |
| PH-CCT0162-USA | Domestic O.D. Vibra Clamp | 1-5/8"           | 10       |
| PH-CCT0212-USA | Domestic O.D. Vibra Clamp | 2-1/8"           | 10       |
| PH-CCT0262-USA | Domestic O.D. Vibra Clamp | 2-5/8"           | 10       |
| PH-CCT0312-USA | Domestic O.D. Vibra Clamp | 3-1/8"           | 10       |

**CALL FOR PRICES**

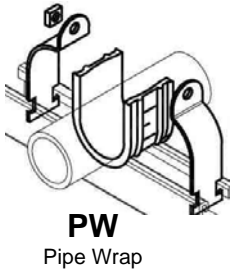

| Item #         | Description                      | Size   | Box Qty. |
|----------------|----------------------------------|--------|----------|
| PH-PW-USA      | Domestic Vibra Cushion Pipe Wrap | 25'    | 1        |
| PH-SCR0075-USA | Domestic Rigid Pipe Clamp        | 3/4"   | 100      |
| PH-SCR0100-USA | Domestic Rigid Pipe Clamp        | 1"     | 100      |
| PH-SCR0150-USA | Domestic Rigid Pipe Clamp        | 1-1/2" | 50       |
| PH-SCR0200-USA | Domestic Rigid Pipe Clamp        | 2"     | 50       |
| PH-SCR0250-USA | Domestic Rigid Pipe Clamp        | 2-1/2" | 50       |
| PH-SCR0300-USA | Domestic Rigid Pipe Clamp        | 3"     | 25       |
| PH-SCU0050-USA | Domestic Multigrip Pipe Clamp    | 1/2"   | 100      |
| PH-SCU0075-USA | Domestic Multigrip Pipe Clamp    | 3/4"   | 100      |
| PH-SCU0100-USA | Domestic Multigrip Pipe Clamp    | 1"     | 100      |
| PH-SCU0125-USA | Domestic Multigrip Pipe Clamp    | 1-1/4" | 50       |
| PH-SCU0150-USA | Domestic Multigrip Pipe Clamp    | 1-1/2" | 50       |
| PH-SCU0200-USA | Domestic Multigrip Pipe Clamp    | 2"     | 50       |

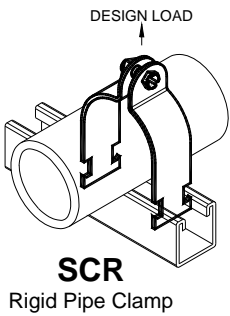

**SCR**  
Rigid Pipe Clamp

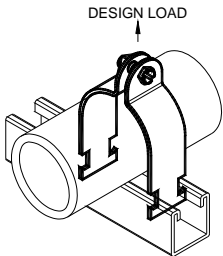

**SCU**  
Universal Pipe Clamp