

Beam Clamps and Steel "C" Clamps

Item #	Description	Size	Finish	Price Ea.
GL-103 101	Top Beam Clamp	3/8"	Plain	\$.5722
GL-103-101-USA	Domestic Top Beam Clamp	3/8"	Plain	\$.7520
GL-103-201-USA	Domestic Top Beam Clamp	3/8"	Plated	\$.8499
GL-104-101-USA	Domestic Top Beam Clamp	1/2"	Plain	\$.7581
GL-104-201-USA	Domestic Top Beam Clamp	1/2"	Plated	\$1.1540
GL-105-101-USA	Domestic Top Beam Clamp	5/8"	Plain	\$2.0738
GL-105-201-USA	Domestic Top Beam Clamp	5/8"	Plated	\$2.2623
GL-106-201-USA	Domestic Top Beam Clamp	3/4"	Plated	\$4.0210
GL-107-201-USA	Domestic Top Beam Clamp	7/8"	Plated	\$4.8419
GL-113-101-USA	Domestic Wide Mouth Beam Clamp	3/8"	Plain	\$.8922
GL-113-201-USA	Domestic Wide Mouth Beam Clamp	3/8"	Plated	\$1.1457
GL-114-101-USA	Domestic Wide Mouth Beam Clamp	1/2"	Plain	\$1.0575
GL-114-201-USA	Domestic Wide Mouth Beam Clamp	1/2"	Plated	\$1.6816
GL-203-101-USA	Domestic Steel "C" Clamp w/ Nut	3/8"	Plain	\$.7484
GL-203-201-USA	Domestic Steel "C" Clamp w/ Nut	3/8"	Plated	\$1.2048
GL-204-101-USA	Domestic Steel "C" Clamp w/ Nut	1/2"	Plain	\$1.0816
GL-204-201-USA	Domestic Steel "C" Clamp w/ Nut	1/2"	Plated	\$1.6635

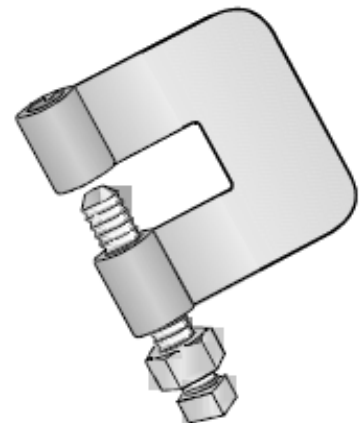
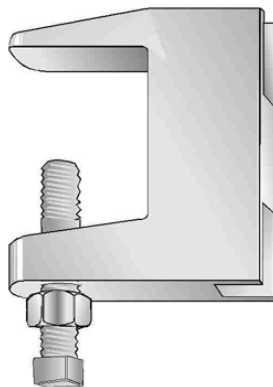

DRIVEKORE

101 Wesley Drive • Mechanicsburg, PA 17055 • Phone: (717) 766-7636 • Toll-Free (800) 382-1311
Fax: (717) 697-7477 • Toll-Free Fax: (800) 739-1101 • Email: orders@DriveKore.com

www.DriveKore.com